



Alcohol and Entertainment Licensing Sub-Committee

Monday 26 February 2024 at 2.00pm

Boardrooms 7 & 8, 3rd Floor, Brent Civic Centre

Please note that this meeting will be held in person with members of the Sub-Committee required to attend in person.

The press and public are also welcome to attend this meeting in person. Please note the meeting is not scheduled for live webcast
Membership:

Members

Councillors:

Ahmed (Chair)
Collymore
Rubin

Substitute Members

Councillors:

Bajwa, Chohan, Ethapemi, Hack, Long, Mahmood,
Lorber

For further information contact: Devbai Bhanji, Governance Assistant
Tel: 020 8937 6841; Email: devbai.bhanji@brent.gov.uk

For electronic copies of minutes and agendas please visit:
[Council meetings and decision making | Brent Council](#)

Notes for Members - Declarations of Interest:

If a Member is aware they have a Disclosable Pecuniary Interest* in an item of business, they must declare its existence and nature at the start of the meeting or when it becomes apparent and must leave the room without participating in discussion of the item.

If a Member is aware they have a Personal Interest** in an item of business, they must declare its existence and nature at the start of the meeting or when it becomes apparent.

If the Personal Interest is also significant enough to affect your judgement of a public interest and either it affects a financial position or relates to a regulatory matter then after disclosing the interest to the meeting the Member must leave the room without participating in discussion of the item, except that they may first make representations, answer questions or give evidence relating to the matter, provided that the public are allowed to attend the meeting for those purposes.

***Disclosable Pecuniary Interests:**

- (a) **Employment, etc.** - Any employment, office, trade, profession or vocation carried on for profit gain.
- (b) **Sponsorship** - Any payment or other financial benefit in respect of expenses in carrying out duties as a member, or of election; including from a trade union.
- (c) **Contracts** - Any current contract for goods, services or works, between the Councillors or their partner (or a body in which one has a beneficial interest) and the council.
- (d) **Land** - Any beneficial interest in land which is within the council's area.
- (e) **Licences**- Any licence to occupy land in the council's area for a month or longer.
- (f) **Corporate tenancies** - Any tenancy between the council and a body in which the Councillor or their partner have a beneficial interest.
- (g) **Securities** - Any beneficial interest in securities of a body which has a place of business or land in the council's area, if the total nominal value of the securities exceeds £25,000 or one hundredth of the total issued share capital of that body or of any one class of its issued share capital.

****Personal Interests:**

The business relates to or affects:

- (a) Anybody of which you are a member or in a position of general control or management, and:
 - To which you are appointed by the council;
 - which exercises functions of a public nature;
 - which is directed is to charitable purposes;
 - whose principal purposes include the influence of public opinion or policy (including a political party or trade union).
- (b) The interests a of a person from whom you have received gifts or hospitality of at least £50 as a member in the municipal year;

or

A decision in relation to that business might reasonably be regarded as affecting the well-being or financial position of:

- You yourself;
- a member of your family or your friend or any person with whom you have a close association or any person or body who is the subject of a registrable personal interest.

Agenda

Introductions, if appropriate.

Item	Page
1 Apologies for absence and clarification of alternate members	
2 Declarations of Interests	
Members are invited to declare at this stage of the meeting, the nature and existence of any relevant disclosable pecuniary or personal interests in the items on this agenda and to specify the item(s) to which they relate.	
3 Application for Variation to an Adult Gaming Centre by Future Leisure Ltd for the premises known as Royal Slots, 9A Walm Lane, NW2 5SJ, pursuant to the provisions of the Licensing Act 2003	1 - 28

Date of the next meeting: Date Not Specified



- Please remember to **SWITCH OFF** your mobile phone during the meeting.
- The meeting room is accessible by lift and seats will be provided for members of the public. Alternatively, it will be possible to follow proceedings via the live webcast [HERE](#)

This page is intentionally left blank

Gambling Act 2005

Application for Variation to an Adult Gaming Centre

1. The Application

Name of Applicant:	Future Leisure Ltd
Name & Address of Premises:	Royal Slots, 9A Walm Lane, NW2 5SJ
Applicants Agent:	Woods Whur 2014 Ltd

The application is for an Adult Gaming Centre

2. Background

None

3. Relevant Representations

Representations were received and withdrawn from the Licensing Officers.
Representations remain outstanding from the Ward Councillor.

4. Interested Parties

None

5. Policy Considerations

None specific

6. Associated Papers

- A. Copy of Application Form
- B. Copies of Representations
- C. Location Map

This page is intentionally left blank

Application to vary a premises licence under the Gambling Act 2005

PLEASE READ THE FOLLOWING INSTRUCTIONS FIRST

If you are completing this form by hand, please write legibly in block capitals using ink. Use additional sheets if necessary (marked with the number of the relevant question). You may wish to keep a copy of the completed form for your records.

Part 1 - Applicant Details

If you are an individual, please fill in Section A. If the application is being made on behalf of an organisation (such as a company or partnership), please fill in Section B.

Section A

Individual applicant

1 Title: Mr Mrs Miss Ms Dr Other (please specify) [*****]

2 Surname: [*****] Other name(s): [*****]

3 Applicant's address (home or business -):

[*****]

[*****]

[*****]

Postcode: [*****]

4(a) The number of the applicant's operating licence (as set out in the operating licence): [*****]

4(b) If the applicant does not hold an operating licence but is in the process of applying for one, give the date on which the application was made: [*****]

5 Tick the box if the application is being made by more than one person.

Section B

Application on behalf of an organisation

6 Name of applicant business or organisation: Future Leisure Limited

7 The applicant's registered or principal address:

Fawley House
2 Regatta Place
Marlow Road
Bourne End
Buckinghamshire
Postcode: SL8 5TD

8(a) The number of the applicant's operating licence (as given in the operating licence):

000-036646-N-318600-006

8(b) If the applicant does not hold an operating licence but is in the process of applying for one, give the date on which the application was made: [*****]

9 Tick the box if the application is being made by more than one organisation.

Part 2 - Premises Details

10 Trading name used at licensed premises: Royal Slots

11 Give the address of the premises or, if none, give a description of the premises and its location. Where the premises are a vessel, give the place indicated in the premises licence as the place in the licensing authority's area where the vessel is wholly or partly situated. Where possible this should include an address with a postcode:

9A Walm Lane
London
Postcode: NW2 5SJ

12 Telephone number at premises (if known): [*****]

13 Type of premises licence to be varied:

Regional Casino <input type="checkbox"/>	Large Casino <input type="checkbox"/>	Small Casino <input type="checkbox"/>
Converted Casino <input type="checkbox"/>	Bingo <input type="checkbox"/>	Adult Gaming Centre <input checked="" type="checkbox"/>
Betting (track) <input type="checkbox"/>	Betting (other) <input type="checkbox"/>	Family Entertainment Centre <input type="checkbox"/>

- 14 Premises licence number (if known): 11955
- 15 If you are making this application alongside an application for transfer or reinstatement of the premises licence into your name, please give the name of the current licence holder as it appears on the premises licence (if known):
- Surname: [*****] Other name(s): [*****]

Part 3 - Details of variations applied for

- 16(a) Please give details of any variation which is being applied for. Where the application includes an application to exclude or vary a condition of the premises licence, identify the relevant condition here (unless it relates to hours of operation which are dealt with in questions 16(b) and 16(c)):

The proposed variation is to vary the condition which currently reads “There will be a minimum of 2 staff members present at all times when the premises are open” to read “There will be a minimum of 2 staff members present at all times after 12pm”.

To remove the condition which reads “A clear and unobstructed view into the premises is to be maintained. This is to be achieved by having clear, non-tinted glass in the entrance door and front windows, no signage or visual obstructions on the entrance door, and one of the two window displays as shown on the plans submitted and approved with the application”.

- 16(b) Do you want the licensing authority to exclude or vary a condition of the licence so that the premises may be used for longer periods than would otherwise be the case?

No

- 16(c) If the answer to question 16(b) is yes, please complete the table below to indicate the times when you want the premises to be available for use under the premises licence.

	Start	Finish	Details of any seasonal variation
Mon			[*****]
Tues			[*****]
Wed			[*****]
Thurs			[*****]
Fri			[*****]
Sat			[*****]

Sun			[*****]
17	Please indicate any particular date on which you want the variation to take effect if approved: ASAP		
18	Please set out any other matters which you consider to be relevant to your application:		

Part 4 - Declarations and Checklist (Please tick as appropriate)

~~I~~ We confirm that, to the best of my/ our knowledge, the information contained in this application is true. ~~I~~ We understand that it is an offence under section 342 of the Gambling Act 2005 to give information which is false or misleading in, or in relation to, this application.

~~I~~ We confirm that the applicant(s) have the right to occupy the premises.

Checklist:

- Payment of the appropriate fee has been made/is enclosed
- A plan of the premises is enclosed
- The existing premises licence is enclosed
- The existing premises licence is not enclosed, but the application is accompanied by -
 - A statement explaining why it is not reasonably practicable to produce the licence and,
 - An application under the Section 190 of the Gambling Act 2005 for the issue of a copy of the licence
- ~~I~~we understand that if the above requirements are not complied with the application may be rejected
- ~~I~~ we understand that it is now necessary to advertise the application and give the appropriate notice to the responsible authorities

Part 5 - Signatures

19 Signature of applicant or applicant's solicitor or other duly authorised agent. If signing on behalf of the applicant, please state in what capacity:

Woods Whur

Signature:

Print Name: Woods Whur

Date: 9 January 2024 Capacity: Solicitors for the Applicant

20 For joint applications, signature of 2nd applicant, or 2nd applicant's solicitor or other authorised agent. If signing on behalf of the applicant, please state in what capacity:

Signature: [*****]

Print Name: [*****]

Date: [*****] (dd/mm/yyyy) Capacity: [*****]

Part 6 - Contact Details

21(a) Please give the name of a person who can be contacted about the application: Andrew Woods

21(b) Please give one or more telephone numbers at which the person identified in question 21 (a) can be contacted: 0113 234 3055

22 Postal address for correspondence associated with this application:

Woods Whur

St James House

28 Park Place

Leeds

Postcode: LS1 2SP

23 If you are happy for correspondence in relation to your application to be sent via e-mail, please give the e-mail address to which you would like correspondence to be sent:
Andrew@woodswhur.co.uk

From: Long, Councillor Janice <cllr.janice.long@brent.gov.uk>
Sent: Sunday, February 4, 2024 10:33 PM
To: Business Licence <business.licence@brent.gov.uk>
Cc: Legister, Linda <Linda.Legister@brent.gov.uk>; Prashar, Anu <Anu.Prashar@brent.gov.uk>
Subject: Re: Gambling Premises Licence Variation - Willesden Green - 30528

I am objecting to the proposed changes to conditions for Casino Slots, 9a Walm Lane.

Safety of staff and customers is important and removing these conditions will increase the risk to staff and customers.

The existing layout already has blind spots and obscuring sight lines further by installing obscured glazing on the door and adjacent windows will reduce sight lines into the premises. Visibility of the far left corner is already blocked by a row of machines. Obscured glass on the door and adjacent window will also block views into the far right corner of the premises. Note that the repeated blocking of the door and windows has shown this to be the case.

With the door and windows obscured staff using the desk/office in the far left corner will not have clear sight lines of the door or the footway outside. So they will not be able to check the age or intoxication levels of a customer until the customer has walked well into the premises and become visible. Also sight lines to the pavement are blocked by the row of machines which are parallel to the pavement.

Lone working is an acknowledged risk. Reducing the number of staff to one will increase this risk. And reducing the number of staff and obscuring sight lines further increases the risk to safety of staff.

Cllr Janice Long
Willesden Green ward

Cllr Janice Long
Willesden Green Ward / LB Brent
Cllr.janice.long@brent.gov.uk
07920 378716 / 020 8459 7435
Twitter @CllrLong

This page is intentionally left blank

Andrew Woods
Woods Whur
St James House
28 Park Place
Leeds
LS1 2SP

5 February 2024

Ref: 30528

Dear Andrew Woods,

Gambling Act 2005 - Application to Vary a Premises Licence AGC
Re: Royal Slots, 9a Walm Lane, NW2 5SJ

I certify that I have considered the above application and I wish to make representations that the likely effect of the grant of the application is detrimental to the Licensing Objectives for the reasons indicated below.

Officer: Esther Chan – Licensing Inspector

An officer of the Licensing Authority, in whose area the premises are situated, who is authorised for the purposes of exercising its statutory function as a 'Responsible Authority' under the Gambling Act 2005

The Licensing Authority representations are primarily concerned with the three licensing objectives;

- **Preventing gambling from being a source of crime and disorder, being associated with crime or disorder or being used to support crime**
- **Ensuring that gambling is conducted in a fair and open way**
- **Protecting children and other vulnerable persons from being harmed or exploited by gambling.**

Following our recent communication, I have considered your client's proposal to vary the existing conditions attached to the premises licence and propose the following:

Removal of:

- There will be a minimum of 2 staff members present at all times when the premises are open.
- A clear and unobstructed view into the premises is to be maintained. This is to be achieved by having clear, non-tinted glass in the entrance door and front windows, no signage or visual obstructions on the entrance door, and one of the two window displays as shown on the plans submitted and approved with the application.

Replaced with the following new proposed conditions:

- 1) There will be a minimum of 2 staff members present at all times between 12pm to 6am.
- 2) Lone working staff will be provided and required to carry on their person a personal fob alarm which will activate the alarm if pressed by the member of staff or that staff member is lying horizontal for a pre-determined period of time.
- 3) An attack alarm shall be installed and maintained behind the cashier counter which would alert the police.

For the purpose of proportionality and consistency, the Licensing Authority would ask that the aforementioned conditions be applied to the entire licence and not just the varied elements.

In order for the Licensing Authority to withdraw this representation, it will be necessary for you to confirm in writing that your client is willing to accept the above conditions.

Yours sincerely,



Esther Chan
Licensing Inspector
Regulatory Services

From: Esther, Chan
Sent: Tuesday, February 6, 2024 8:42 AM
To: Andrew Woods Carole Collingwood
Cc: Business Licence; Legister, Linda
Subject: RE: CONSULT: Adult gaming Centre Variation - Royal Slots, 9a Walm Lane, NW2 5SJ - 30528

Dear Andrew,

Thank you for your email.

I now wish to withdraw my representation and have no further comments.

Kind Regards

Esther Chan
Licensing Inspector

From: Andrew Woods
Sent: Monday, February 5, 2024 6:11 PM
To: Esther, Chan; Carole Collingwood; Andrew Woods
Cc: Business Licence; Legister, Linda
Subject: RE: CONSULT: Adult gaming Centre Variation - Royal Slots, 9a Walm Lane, NW2 5SJ - 30528

Hi Esther

I can confirm that the 3 replacement conditions in your rep are all agreed.

Many thanks
Andrew

Andrew Woods

Woods Whur 2014 Ltd

From: Esther, Chan
Sent: Monday, February 5, 2024 08:36
To: Andrew Woods; Carole Collingwood
Cc: Business Licence; Legister, Linda
Subject: RE: CONSULT: Adult gaming Centre Variation - Royal Slots, 9a Walm Lane, NW2 5SJ - 30528

Dear Andrew,

Thank you for the requested information.
Please find attached representation from the Licensing Authority.

Kind Regards
Esther Chan
Licensing Inspector
Regulatory Services

From: Andrew Woods
Sent: Friday, February 2, 2024 6:23 PM
To: Esther, Chan; Carole Collingwood
Cc: Business Licence; Andrew Woods
Subject: RE: CONSULT: Adult gaming Centre Variation - Royal Slots, 9a Walm Lane, NW2 5SJ - 30528

Hi Esther

Hope all well.

Thanks for the e mail. We do trade 24/7 but would only ask for lone working from 0600 to 12 midday.

Hope that helps.

Andrew

Andrew Woods
Woods Whur 2014 Ltd

From: Esther, Chan
Sent: Friday, February 2, 2024 11:58
To: Andrew Woods; Carole Collingwood
Cc: Business Licence
Subject: RE: CONSULT: Adult gaming Centre Variation - Royal Slots, 9a Walm Lane, NW2 5SJ - 30528

Dear Andrew,

Thank you for the information.

I am in process of finalising my representation but require further clarification on the below proposed condition:

- 1) *There will be a minimum of 2 staff members present at all times after 12pm.*

Can you confirm if the premises is open 24 hours and what time will lone working commence?

Kind Regards

Esther Chan
Licensing Inspector
Regulatory Services

From: Andrew Woods
Sent: Thursday, February 1, 2024 5:23 PM
To: Esther, Chan; Andrew Woods; Carole Collingwood
Cc: Business Licence
Subject: RE: CONSULT: Adult gaming Centre Variation - Royal Slots, 9a Walm Lane, NW2 5SJ - 30528

Hi Esther

Further to your e mail below please see the answers to the questions you have raised - I hope these are helpful but please let me know if you require further information.

Question 1

- The proposed variation is to vary the condition which currently reads “There will be a minimum of 2 staff members present at all times when the premises are open” to read “There will be a minimum of 2 staff members present at all times after 12pm”.

Please can you confirm what safety measures are in place when staff are lone working?

- Future Leisure (Premises Licence Holder) is a family owned and operated business which takes the safety of its staff very seriously and it has in place measures to protect staff at all times
- The venue has a 16 way CCTV Camera system
- Most importantly this camera system can be viewed in real time by the staff on site and by the area managers and senior management off site at all times ie Senior management can watch the premises on their phone through the CCTV system in real time.
- There are Maglocks fitted to the front door , rear door, toilet and staff office area which can be activated at any time by staff
- The venue has fixed panic buttons linked to the police around the shop.
- There are also 2 remote panic buttons on site at all times which staff have with them and activate at any time
- There is also a system from Staff Guard in place, which is linked to CCTV and the police (it's a remote monitoring station which can talk through to customers and staff in the shop, and respond to any issues)

Question 2.

- To remove the condition which reads “A clear and unobstructed view into the premises is to be maintained. This is to be achieved by having clear, non-tinted glass in the entrance door and front windows, no signage or visual obstructions on the entrance door, and one of the two window displays as shown on the plans submitted and approved with the application”

Please provide an explanation why your client would like to remove this condition in light that the licensing sub-committee imposed this condition?

- Our clients would like this condition removing mainly for the safety and security of our staff and business. As an example a clear view into the venue exposes staff when they are opening machines.
- Interestingly we have come across licensing authorities who want the opposite of this condition to ensure that children and young people cannot see into the venue and what is going on inside. It is argued that the licensing objectives are better promoted with no clear view etc.
- It is also right to say that customers like privacy.
- The unobstructed view is not helpful in terms of both customer and staff safety
- Looking at other premises in Brent the following all appear not have a clear and unobstructed view. This is not alleging breach of any conditions as we don't know what they are but we do know that these premises do not have a clear and unobstructed view etc

Merkur Slots – 51-55 High Road, London, NW10 2SU

Merkur Slots – 304 Neasden Lane, London, NW10 0AD

Admiral - 160 Cricklewood Broadway, London, NW2 3ED

Admiral – 251-253 Neasden Lane, London, NW10 1QG

Merkur Slots – 478 High Road, Wembley, HA9 7BH

Silvertime – 446 High Road, Wembley, HA9 6AH

Silvertime - 527 High Road, Wembley, HA0 2DH

Silvertime – 10 Bank Buildings, High Street, London, NW10 4LT

Andrew Woods

Woods Whur 2014 Ltd

From: Esther, Chan

Sent: Wednesday, January 31, 2024 16:37

To: Andrew Woods

Cc: Business Licence

Subject: CONSULT: Adult gaming Centre Variation - Royal Slots, 9a Walm Lane, NW2 5SJ - 30528

GAMBLING ACT 2005

Licence: Adult Gaming Centre Premises Licence Variation

Reference: 30528

Dear Sir/Madam,

Applicant: **Future Leisure Ltd**

Premises: **Royal Slots, 9a Walm Lane, NW2 5SJ**

On the behalf of the Licensing Authority, I am in process of assessing the application to vary the premises licence. To assist with my assessment, please can you provide information on the following points:

- The proposed variation is to vary the condition which currently reads “There will be a minimum of 2 staff members present at all times when the premises are open” to read “There will be a minimum of 2 staff members present at all times after 12pm”.

Please can you confirm what safety measures are in place when staff are lone working?

- To remove the condition which reads “A clear and unobstructed view into the premises is to be maintained. This is to be achieved by having clear, non-tinted glass in the entrance door and front windows, no signage or visual obstructions on the entrance door, and one of the two window displays as shown on the plans submitted and approved with the application”

Please provide an explanation why your client would like to remove this condition in light that the licensing sub-committee imposed this condition?

Kind Regards

Esther Chan
Licensing Inspector
Regulatory Services

This page is intentionally left blank



Brent

Licence Number: 11955

Adult Gaming Centre Premises Licence

This licence is issued under section 164 of the Gambling Act 2005 by

LONDON BOROUGH OF BRENT

Part 1 – Details of person to whom licence is issued

This premises licence is issued to:

Future Leisure Limited

of the following address:

**Unit 20 Fleetway Business Park, 14-16 Wadsworth Road, Greenford,
Middlesex, UB6 7LD**

who holds an operating licence which has been given the following operating number
by the Gambling Commission: **000-036646-N-318600-006**

Part 2 – Details of the premises in respect of which the licence is issued

Facilities for gambling may be provided in accordance with this licence on the
following premises:

9A Walm Lane, London, NW2 5SJ

Part 3 – Premises Licence details

This licence came into effect on: **4 July 2018**

This licence is of unlimited duration.

The following conditions have been attached to the licence by the issuing authority
under section 169(1)(a) of the Gambling Act 2005:

ANNEX A - CONDITIONS TO BE ATTACHED

Condition to be attached	Reasons for attaching condition
<p>A comprehensive CCTV system shall be installed and maintained on the premises as required by the Metropolitan Police Licensing Team. CCTV should cover the following:</p> <ul style="list-style-type: none"> a) All entry and exit points to and from the premises enabling frontal identification of every person entering under any light conditions; b) The areas of the premises to which the public have access (excluding toilets); and c) Gaming machines and the counter area. 	<p>This condition was agreed with the Licensing Authority and imposed by the sub-committee.</p>
<p>The CCTV shall continue to record activities 24 hours a day and shall be kept for 31 days.</p>	<p>This condition was agreed with the Licensing Authority and imposed by the sub-committee.</p>
<p>The premises shall display notices near the entrance of the venue stating that CCTV is in operation.</p>	<p>This condition was agreed with the Licensing Authority and imposed by the sub-committee.</p>
<p>CCTV shall be made available for the police and licensing authority viewing at any time with minimum delays when requested.</p>	<p>This condition was agreed with the Licensing Authority and imposed by the sub-committee.</p>
<p>A monitor shall be placed inside the premises above the front door showing CCTV images of customers entering exiting the premises.</p>	<p>This condition was agreed with the Licensing Authority and imposed by the sub-committee.</p>
<p>The Licensee shall maintain a bound and paginated 'Challenge 25 Refusals' register at the premises. The register shall be produced to the police or licensing authority forthwith on request.</p>	<p>This condition was agreed with the Licensing Authority and imposed by the sub-committee.</p>
<p>Prominent signage and notices advertising the Challenge 25 will be displayed showing the operation of such policy.</p>	<p>This condition was agreed with the Licensing Authority and imposed by the sub-committee.</p>
<p>Third party testing on age restricted sales systems purchasing shall take place at least twice a year and the results shall be provided to the Licensing Authority upon request.</p>	<p>This condition was agreed with the Licensing Authority and imposed by the sub-committee.</p>
<p>A Challenge 25 proof of age scheme shall be operated at the premises where the only acceptable forms of identification are recognised photographic identification cards, such as a driving licence, passport or proof of age card with the PASS Hologram.</p>	<p>This condition was agreed with the Licensing Authority and imposed by the sub-committee.</p>

The Licensee shall implement a policy of banning any customers who engage in crime or disorder within or outside the premises.	This condition was agreed with the Licensing Authority and imposed by the sub-committee.
The licensee will refuse entry to customers who appear to be under the influence of alcohol or drugs.	This condition was agreed with the Licensing Authority and imposed by the sub-committee.
The licensee shall ensure that all seating within the premises are either secured to the floor or are weighted to prevent lifting.	This condition was agreed with the Licensing Authority and imposed by the sub-committee.
The licensee shall install and maintain an intruder alarm on the premises.	This condition was agreed with the Licensing Authority and imposed by the sub-committee.
The premises shall install and maintain a panic button conveniently available to staff.	This condition was agreed with the Licensing Authority and imposed by the sub-committee.
There shall be a locking device on the front door at all times.	This condition was agreed with the Licensing Authority and imposed by the sub-committee.
All doors and windows shall remain closed during any licensable activity save when people are entering or exiting.	This condition was agreed with the Licensing Authority and imposed by the sub-committee.
The licensee will ensure that customer toilets are checked every hour for evidence of drug taking. Toilet checks are to be documents stating the time and member of staff who made the checks.	This condition was agreed with the Licensing Authority and imposed by the sub-committee.
Toilet doors shall be kept locked and access given by staff only.	This condition was agreed with the Licensing Authority and imposed by the sub-committee.
Prominent GamCare documentation will be displayed at the premises.	This condition was agreed with the Licensing Authority and imposed by the sub-committee.
The licensee shall: provide training on the specific local risks to the licensing objectives that have been identified for these premises as part of the staff induction training programme. periodically provide refresher training to all of its staff working at these premises on the specific local risks to the licensing objectives. Participation in this training shall be formally recorded on each member of staffs training records which, if requested will be presented to the Licensing Authority as soon as practicable.	This condition was agreed with the Licensing Authority and imposed by the sub-committee.

<p>The Licensee shall train staff on specific issues related to the local area and shall conduct periodic refresher training. Participation in this training shall be formally recorded and the records produced to the police or licensing authority upon request.</p>	<p>This condition was agreed with the Licensing Authority and imposed by the sub-committee.</p>
<p>New and seasonal staff must attend induction training and receive refresher training every six months. Participation in this training shall be formally recorded and the records produced to the police or licensing authority upon request.</p>	<p>This condition was agreed with the Licensing Authority and imposed by the sub-committee.</p>
<p>The Licensee shall take all reasonable steps to prevent street drinking of alcohol directly outside the premises and to ban from the premises those who do so.</p>	<p>This condition was agreed with the Licensing Authority and imposed by the sub-committee.</p>
<p>The Licensee shall place a notice visible from the exterior of the premises stating that customers drinking alcohol outside the premises is not permitted and those who do so will be banned from the premises.</p>	<p>This condition was agreed with the Licensing Authority and imposed by the sub-committee.</p>
<p>An incident log shall be kept for the premises and made available on request to an authorised officer of the City Council or the Police which will record the following;</p> <ul style="list-style-type: none"> a) All crimes reported to the venue; b) Any complaints received regarding crime and disorder; c) Any incidents of disorder; d) Any faults in the CCTV system; and e) Any visit by a relevant authority or emergency service. f) Refusals, banned and self-excluded customers. 	<p>This condition was agreed with the Licensing Authority and imposed by the sub-committee.</p>
<p>A fire alarm and smoke detection system will be installed.</p>	<p>This condition was agreed with the Licensing Authority and imposed by the sub-committee.</p>
<p>There will be a minimum of 2 staff members present at all times when the premises are open.</p>	<p>This condition was imposed by the sub-committee as being a necessary and proportionate measure.</p>

<p>A clear and unobstructed view into the premises is to be maintained. This is to be achieved by having clear, non-tinted glass in the entrance door and front windows, no signage or visual obstructions on the entrance door, and one of the two window displays as shown on the plans submitted and approved with the application.</p>	<p>This condition was imposed by the sub-committee as being a necessary and proportionate measure.</p>
--	---

ANNEX B - EXCLUDED CONDITIONS

The following conditions, which would otherwise attach to the licence by virtue of regulations made under section 168 of the Gambling Act 2005, have been excluded by the issuing authority under section 169(1)(b) of that Act:

N/A

ANNEX C - REPRESENTATION

Representation	Licensing authority's response
Metropolitan Police	Valid
Licensing	Valid

A scale plan is attached as an annex to this licence

Signed on behalf of the issuing licensing authority

Signed..... *AKtar. Choudhary*
 Operational Director, Planning & Regeneration

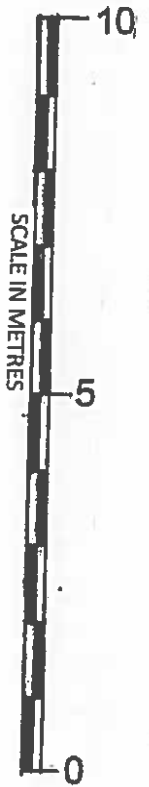
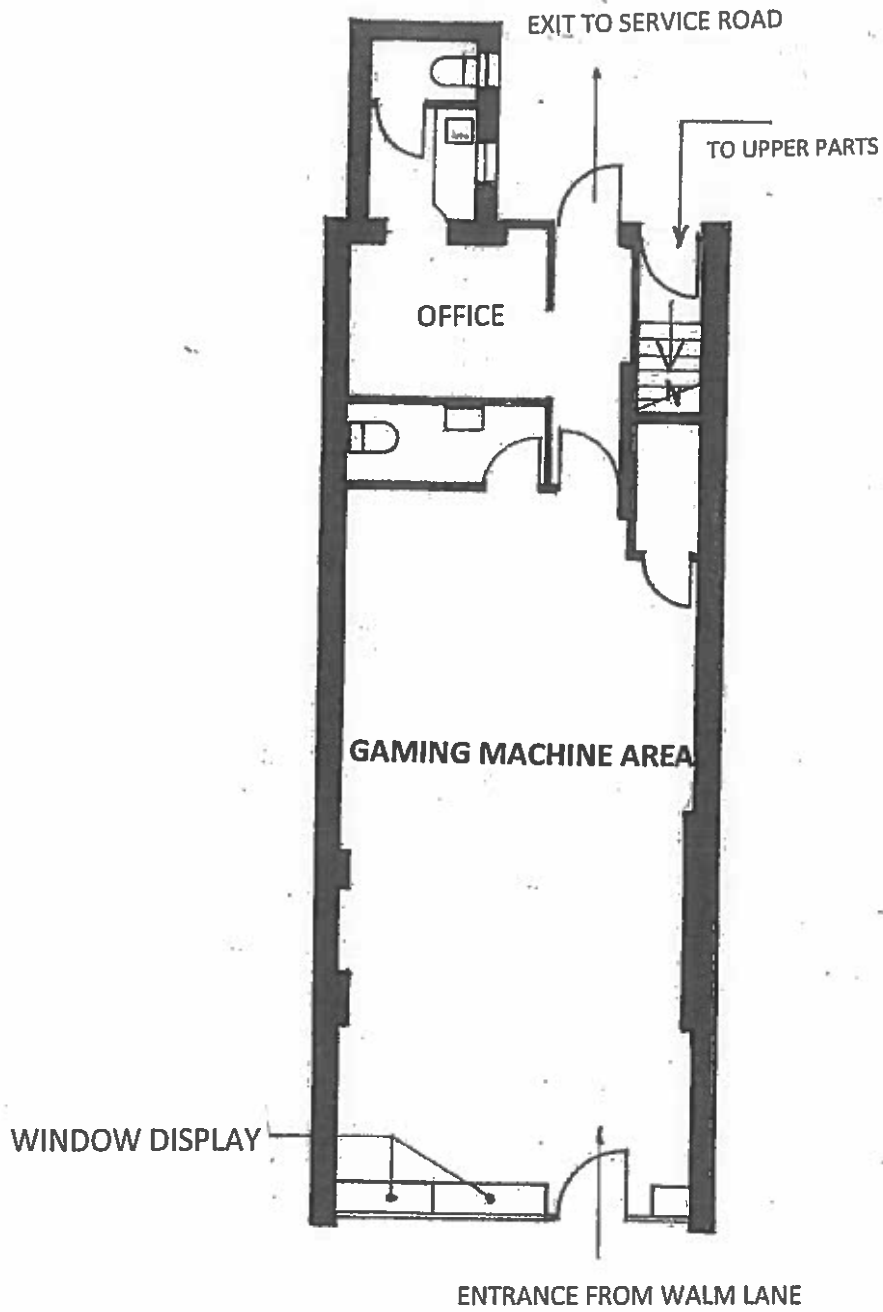

9A WALM LANE, LONDON, NW2 5SJ - LICENCE PLAN – SCALE 1:100

Basemap Map



1:1250

0 0.02 0.04 kilometres



Brent

This page is intentionally left blank

From: Andrew Woods
Sent: Thursday, February 8, 2024 4:32 PM
To: Long, Councillor Janice
Cc: Business Licence; Esther, Chan; Andrew Woods; Carole Collingwood
Subject: Cllr Long Royal Slots, 9A Walm Lane, NW2 5SJ

Dear Cllr Long

Hope you are well. I am instructed by Future Leisure Ltd who are the operators of the above premises and I have been forwarded your representation of 4th February 2024.

As I am sure you will be aware Licensing Committee hearing has been fixed for 26 February at 2 PM for this application to be considered. I am not sure if you are aware that your representation is the only representation against the application and consequently the need for a Licensing Committee hearing.

I hope in those circumstances you don't mind me contacting you but I thought it might assist if I set out some more information about the application and I would also like to invite you if appropriate having considered this email to meet me and the operators on sites so that we can discuss the matter further.

I have also been in contact with Esther Chan (Brent Licensing Inspector) with regard to this application. Esther asked me for further information about the application and as a result of that information we have agreed with Esther that the two conditions that we are seeking to be removed will be replaced with the following three conditions.

- 1) There will be a minimum of 2 staff members present at all times between 12pm to 6am.
- 2) Lone working staff will be provided and required to carry on their person a personal fob alarm which will activate the alarm if pressed by the member of staff or that staff member is lying horizontal for a pre-determined period of time.
- 3) An attack alarm shall be installed and maintained behind the cashier counter which would alert the police

As a result of this agreement Esther has withdrawn any representation against this application and there is no representation from the police.

I am attaching my email to Esther of 1 February which sets out more information about the family-owned business, security and safety measures on site in particular for the staff and an explanation as to why our client is seeking to remove the conditions.

You will note from the email that my clients is a small family-owned business and I can assure you that safety and security of customers and staff is paramount and that in fact that is the reason for the application.

The open frontage or partially open frontage offers an opportunity both for children and young people to look into the venue which in several cases I have been involved

in has been suggested as not being appropriate but also for those who may want to cause trouble to watch the customers inside the venue. It also creates an opportunity for those outside the venue to notice when staff are emptying the machines which in our view is not beneficial to customers or staff for obvious reasons.

I wonder if you would read my email to Esther which sets out all the safety information and note the above conditions agreed and let me know if there is any further information you require. I can confirm that my client would be more than happy to meet you on site as well.

Look forward to hearing from you.

Regards
Andrew

Andrew Woods

Woods Whur 2014 Ltd